



**CONTROLLED  
ACCESS  
CONSULTANTS, INC.**



**YOUR FENCE COMPANY  
0000 STREET ADDRESS  
CITY, STATE 00000  
(000) 000-0000  
MT581-76642**

# PROPOSAL/CONTRACT

03/22/2007

**Customer Information:**

Hershal Dinglethorpe  
3278 N. Bigelow Ave  
Simi Valley, CA 93065

**Job Information:**

\_\_\_\_\_  
\_\_\_\_\_  
\_\_\_\_\_

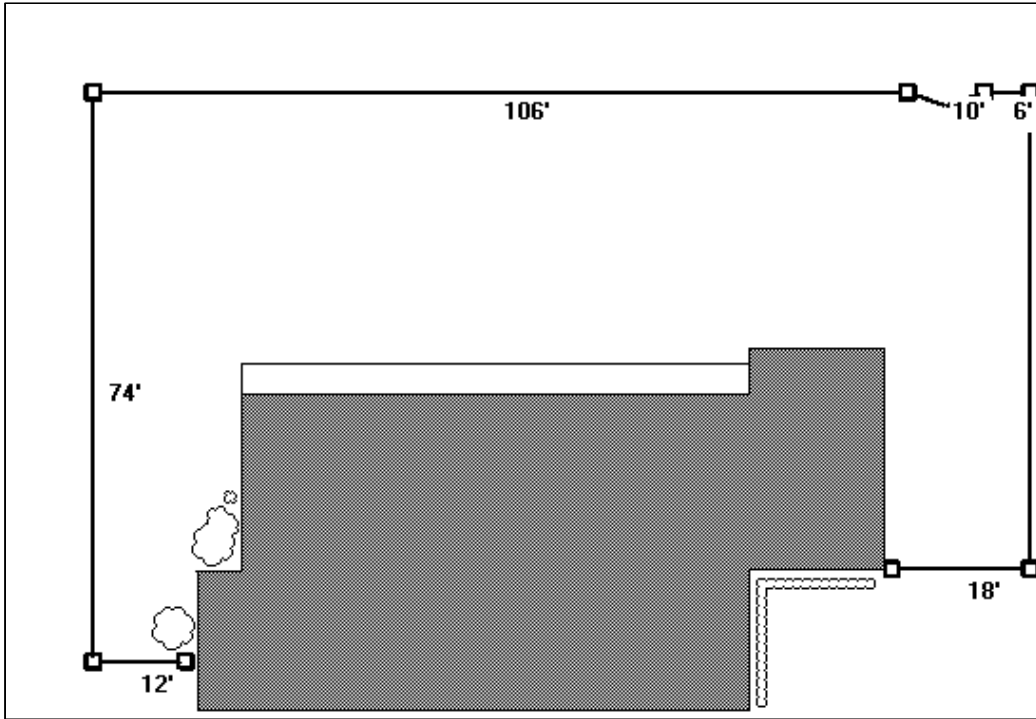

**TERRAIN:**

- LEVEL
- HILLY
- STEEP
- ROCKY
- ASPHALT
- CONCRETE
- \_\_\_\_\_

**OBSTRUCTIONS:**

- OLD FENCE
- TREES
- BUSHES
- SPRINKLER LINES
- \_\_\_\_\_

**Notes:**

PLEASE NOTE THAT ANY MODIFICATIONS TO THE JOB LAYOUT WILL CHANGE THE COST OF THE CONTRACT.

PAYMENT FOR PROJECT IS DUE UPON COMPLETION.

ANY QUESTIONS REGARDING YOUR BILL SHOULD BE DIRECTED TO SUZANNE IN ACCOUNTS.

THANK YOU FOR YOUR BUSINESS.

Contract Amount:	\$	<u>16069.51</u>
Total Sales Tax:	\$	<u>930.03</u>
Total Contract Amount:	\$	<u>16999.54</u>
Down Payment:	\$	<u>5000.00</u>
Balance Due:	\$	<u>11999.54</u>

**Approved & Accepted for Customer:**

_____	_____
Customer	Date
_____	_____
Customer	Date

**Accepted for YOUR FENCE COMPANY:**

_____	_____
Salesperson	Date



**CONTROLLED  
ACCESS  
CONSULTANTS, INC.**



**YOUR FENCE COMPANY  
0000 STREET ADDRESS  
CITY, STATE 00000  
(000) 000-0000  
MT581-76642**

**TERMS & CONDITIONS**

YOUR FENCE COMPANY agrees to guarantee above fence to be free from defects in materials and workmanship for one year.

YOUR FENCE COMPANY shall advise the customer as to local zoning regulations but responsibility for complying with said regulations and obtaining any required permits shall rest with the customer. YOUR FENCE COMPANY will assist the customer, upon request, in determining where the fence is to be erected, but under no circumstance does YOUR FENCE COMPANY assume any responsibility concerning property lines or in any way guarantee their accuracy. If property pins cannot be located it is recommended that the customer have the property surveyed.

YOUR FENCE COMPANY will assume the responsibility for having underground public utilities located and marked. However, YOUR FENCE COMPANY assumes no responsibility for unmarked sprinkler lines, or any other unmarked buried lines or objects. The customer will assume all liability for any damage caused by directing YOUR FENCE COMPANY to dig in the immediate vicinity of known utilities.

The final billing will be based on the actual footage of fencing built and the work performed. Partial billing for materials delivered to the job site and work completed may be sent at weekly intervals. Adjustments for material used on this job and adjustments for labor will be charged or credited at the currently established rates. Additional charges for any extra work not covered in this contract that was requested by the customer will also be added. The full amount of this contract along with any additional charges will become payable upon completion of all work whether or not it has been invoiced.

A finance charge of 1 1/2% per month (or a minimum of \$1.00), which is an annual percentage rate of 18%, shall be applied to accounts that are not paid within 10 days after completion of any work invoiced. All materials will remain the property of YOUR FENCE COMPANY until all invoices pertaining to this job are paid in full. The customer agrees to pay all interest and any costs incurred in the collection of this debt.

CUSTOMER Initial \_\_\_\_\_

CUSTOMER Initial \_\_\_\_\_

SALESPERSON Initial \_\_\_\_\_